

SC/PC STANDARD
OUTER HOUSING

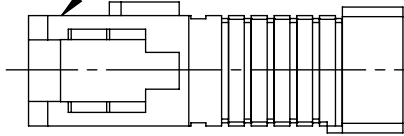

SC/PC STANDARD
INNER FRAME ASSEMBLY

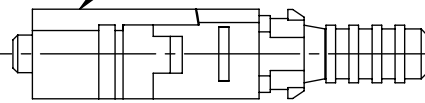

STRAIN RELIEF BOOT USED WITH
900µm FURCATION TUBING

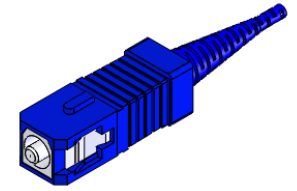
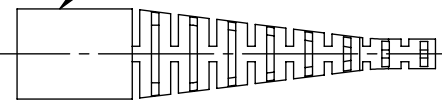

ISOMETRIC VIEW
SCALE 1:1

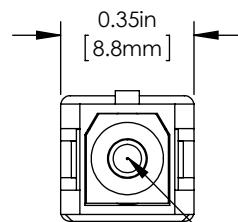

0.35in
[8.8mm]

THRU HOLE
126µm +1/-0µm

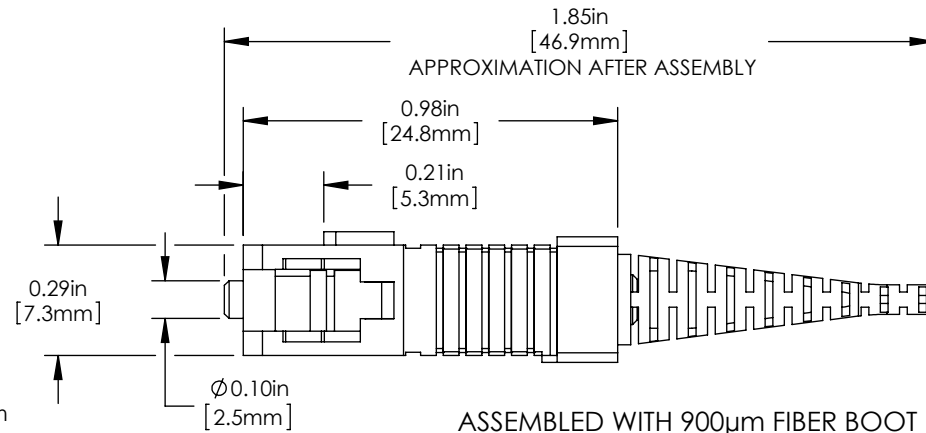

1.85in
[46.9mm]
APPROXIMATION AFTER ASSEMBLY

0.98in
[24.8mm]

0.21in
[5.3mm]

0.29in
[7.3mm]

∅0.10in
[2.5mm]

ASSEMBLED WITH 900µm FIBER BOOT

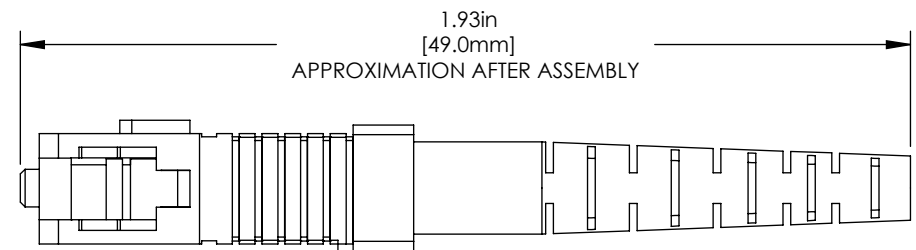

1.93in
[49.0mm]
APPROXIMATION AFTER ASSEMBLY

ASSEMBLED WITH 3.0mm FIBER BOOT



CRIMP SLEEVE
USE ONLY WITH 3.0mm FURCATION
TUBING AND BOOT

STRAIN RELIEF BOOT USED WITH
3.0mm FURCATION TUBING

INCLUDED BUT NOT SHOWN
• PROTECTIVE DUST CAP

FOR INFORMATION ONLY
NOT FOR MANUFACTURING PURPOSES

DRAWING PROJECTION				THORLABS www.thorlabs.com SINGLE MODE SC/PC CONNECTOR 126µm FIBER	
NAME	DATE				
DRAWN	JW	21/JUN/13			MATERIAL
APPROVAL	KH	24/JUN/13			
COPYRIGHT © 2013 BY THORLABS				N/A	
VALUES IN PARENTHESIS ARE CALCULATED AND MAY CONTAIN ROUND OFF ERRORS				ITEM #	APPROX WEIGHT
				30126G1	0.004 kg
				REV	A